

SERIE CDE

Normzylinder

doppelwirkend beidseitig Gelenklager

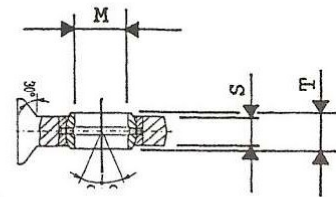
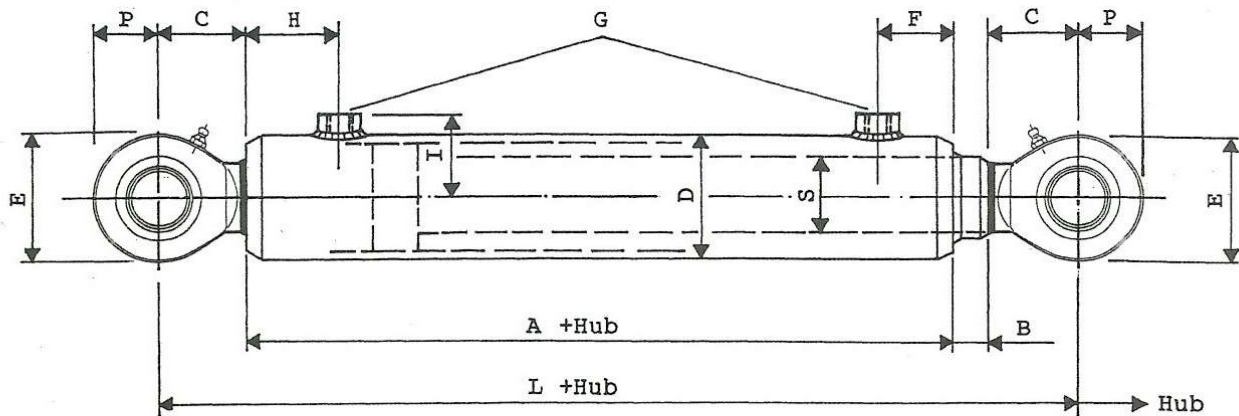

Zylinder Bohrung \varnothing	Kolben stange S	A +Hub	L +Hub	B	C	D	E	F	G	H	I	M	P	S	T
32	18	128	203	13	31	42	40	47	1/4	30	38	15	20	10	12
40	22	140	229	13	38	50	53	52	3/8	30	43	20	26,5	13	16
	28														
50	28	146	250	14	45	60	64	54	3/8	30	49	25	32	17	20
	36														
63	28	150	268	16	51	75	73	52	1/2	35	58	30	36,5	19	22
	36														
	45														
80	36	172	328	18	69	95	92	66	1/2	35	68	40	46	23	28
	45														
	56														
100	45	196	392	20	88	115	111	75	3/4	35	84	50	56	30	35
	56														
	70														
125	56	209	432	23	100	145	135	85	3/4	35	95	60	68	38	44
	70														
	90														